

# Phonak TVLink II

Quick setup guide / Schnellstartanleitung

Guide d'installation rapide / Guía rápida de conexión



**PHONAK**  
life is on

Components  
Komponenten  
Composants  
Componentes

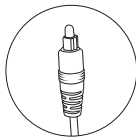

Optical

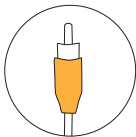

Coaxial



ComPilot II

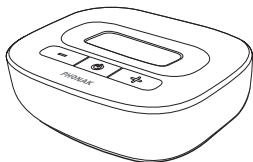
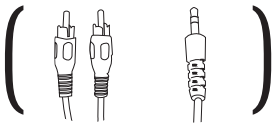

Phonak TVLink II  
basestation

Connect power and audio cable

Netzteil und Audio-Kabel anschliessen

Connectez le câble d'alimentation et le câble audio

Conecte el cable de conexión y el de audio

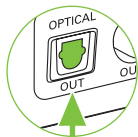
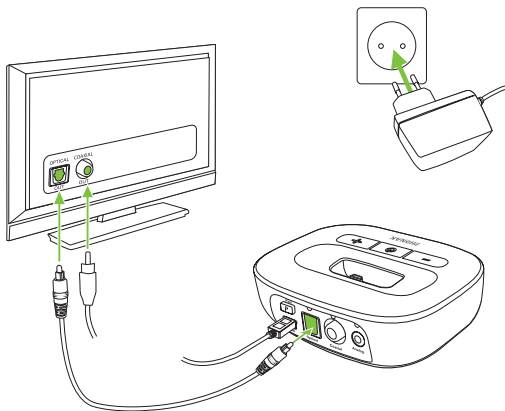

or  
oder  
ou  
o



2

■■■■■

Charge 1 hour  
1 Stunde laden  
Chargez 1 heure  
Cargar 1 ora

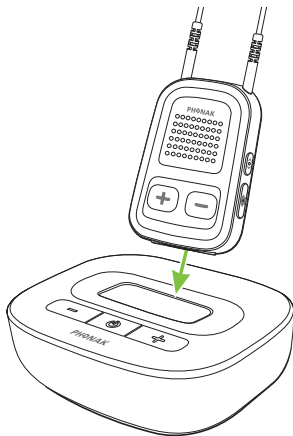

Wearing ComPilot II

ComPilot II tragen

Portez ComPilot II

Llevar ComPilot II

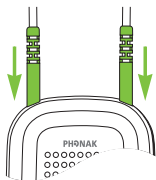
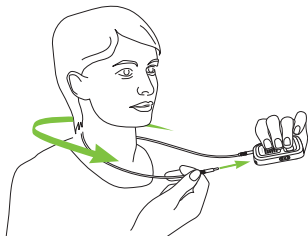
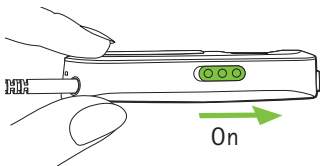

Switch on TVLink II  
TVLink II einschalten  
Mettez TVLink II en marche  
Encienda TVLink II

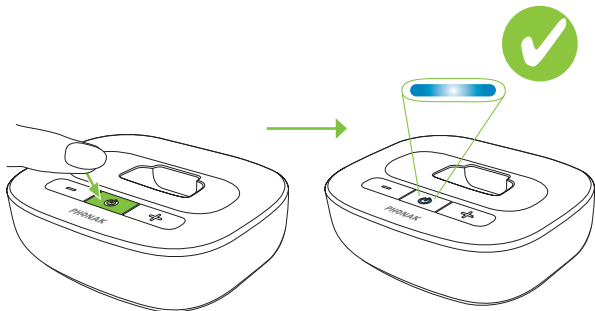

Usage  
Benützung  
Utilisation  
Utilización

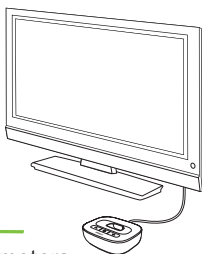

Up to 30 meters  
(100 ft)

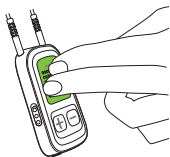

Pause / Resume  
Pause / Abspielen  
Pause / Diffuser  
Pausar / Reanudar

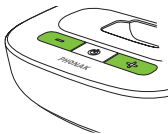

Volume setting  
Lautstärke einstellen  
Réglage de volume  
Ajuste de volumen



The Phonak TVLink II user guide will give you detailed information about the installation.

Die Phonak TVLink II Gebrauchsanweisung informiert detailliert über die Installation.

Le mode d'emploi Phonak TVLink II vous donne des informations détaillées sur l'installation.

Las instrucciones de uso del Phonak TVLink II le darán una información más detallada sobre su instalación.





ON  
Ein  
Marche  
Encendido



No audio signal  
Kein Audiosignal  
Pas de signal audio  
No hay señal audio



Audio transmission  
Tonübertragung  
Transmission audio  
Transmisión audio



Pause  
Pause  
Pause  
No transmisión



Pairing  
Koppeln  
Couplage  
Emparejamiento



Phonak AG  
Laubisrütistrasse 28  
CH-8712 Stäfa  
Switzerland

[www.phonak-us.com](http://www.phonak-us.com)

