

Phonak CROS II

User Guide



PHONAK
life is on

This user guide is valid for:

Wireless models

Phonak CROS II-312

Phonak CROS II-13

CE mark applied

2014

2014

 This user guide only applies to the CROS device.
Please see the hearing aid user guide for instructions related to the hearing aid.



Your CROS device

i If no box is checked and you do not know the model of your CROS device, please ask your hearing care professional.

| Model | Battery type |
|--------------------------------------|---------------------|
| <input type="checkbox"/> CROS II-312 | 312 |
| <input type="checkbox"/> CROS II-13 | 13 |

Earpiece

- Dome or SlimTip
- Classic earmold

Your CROS device has been developed by Phonak – the world leader in hearing solutions based in Zurich, Switzerland.

This premium product is the result of decades of research and expertise and is designed to keep you connected to the beauty of sound! We thank you for making such a great choice and wish you many years of listening pleasure.

Please read the User Guide carefully to make sure that you understand and get the best out of your CROS device. For more information about features and benefits, simply contact your hearing care professional.

Phonak - life is on
www.phonak-us.com

Contents

| | |
|---|----|
| Your CROS device | |
| 1. Quick guide | 6 |
| 2. Parts of your CROS device | 8 |
| Using your CROS device | |
| 3. Left & right CROS device markings | 10 |
| 4. On/Off | 11 |
| 5. Batteries | 12 |
| 6. Putting on your CROS device | 14 |
| 7. Removing your CROS device | 16 |
| 8. Push button | 18 |
| 9. Volume control | 19 |
| Further Information | |
| 10. Care and maintenance | 20 |
| 11. Service and warranty | 23 |
| 12. Compliance information | 25 |
| 13. Information and description of symbols | 29 |
| 14. Troubleshooting | 32 |
| 15. Important safety information | 34 |
| 16. Important information: Cell phones | 41 |
| 17. For the US market only, complies with the FDA regulations | 43 |

1. Quick guide

Left & right markings

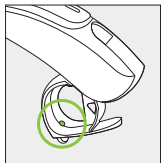

CROS II-312

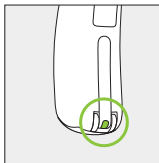

CROS II-13

Blue marking for
left device.

Red marking for
right device.

Changing batteries

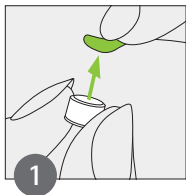

Remove the
sticker from the
new battery.

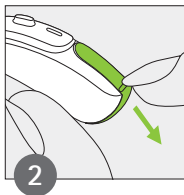

Open the
battery door.

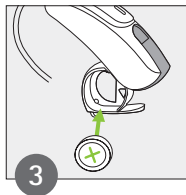

Place battery in
the battery door
with the "+"
symbol facing
upwards.

On/Off

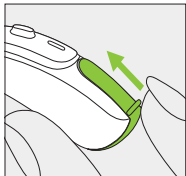

On

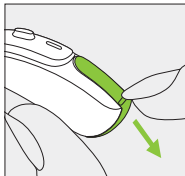

Off

Push button

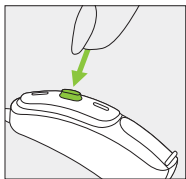

The push button on your device can have various functions. The function is indicated in your individual instructions.

Volume control

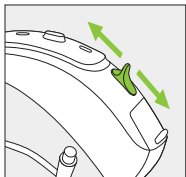

CROS II-13 only:

To increase the volume, press the volume control upwards. To decrease the volume, press the volume control downwards.

2. Parts of your CROS device

The following pictures show the models described in this user guide. You can identify your personal model by:

- Checking "Your CROS device" on page 3.
- Or comparing your CROS device with the models shown on the following page. Pay attention to the shape of the hearing aid and if a volume control is present.

The Phonak CROS device is a solution for single-sided deafness, one-sided hearing loss or asymmetrical hearing loss. It is placed on the poorer hearing ear and wirelessly transmits sound to the Phonak hearing aid on the other ear.

Phonak CROS II device + Phonak hearing aid =
Phonak CROS system

(i) Phonak CROS II only works in connection with a Phonak Venture hearing aid or newer.

CROS II-312

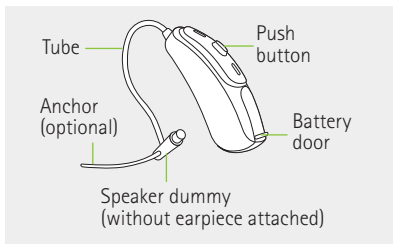

CROS II-13

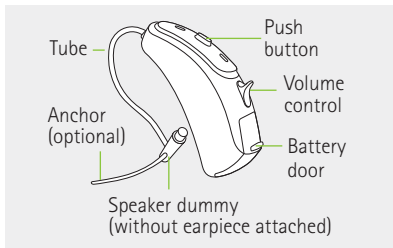

Possible earpieces for the CROS II device



Dome



SlimTip



Classic earmold*

* for CROS II-13 only

3. Left & right CROS device markings

There is a red or blue marking to tell you if it is a left or a right device.

CROS II-312 only:

To open the battery door, pull down the ridge at the bottom of the device.

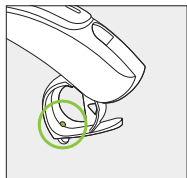
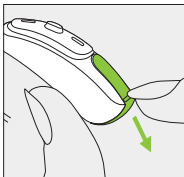

CROS II-312

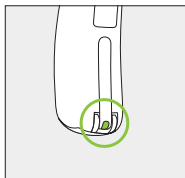

CROS II-13

Blue marking for
left device.

Red marking for
right device.

4. On/Off

The battery door is also the on/off switch.

1

Closed battery door =
CROS device is **on**

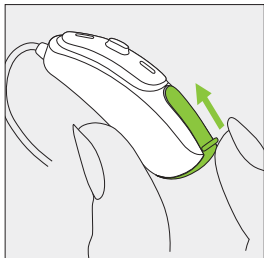

2

Open battery door =
CROS device is **off**

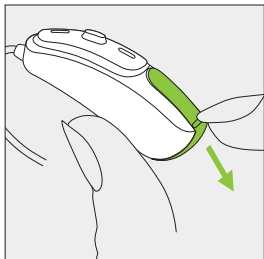

5. Batteries

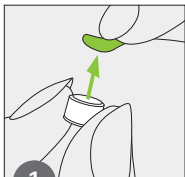

1 Remove the sticker from the new battery.

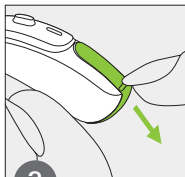

2 Open the battery door.

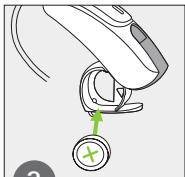

3 Place battery in the battery door with the "+" symbol facing upwards.

- ⓘ If it is difficult to close the battery door: Check that the battery is inserted correctly and the "+" symbol is facing upwards. If the battery is not inserted correctly, the CROS device will not work and the battery door can be damaged.



Low power: You will hear two beeps followed by a melody  when the battery of the CROS device is low. You will have approximately 30 minutes to

change the battery (this can vary, depending on the battery). We recommend that you always have a new battery at hand.

Replacement battery

This CROS device requires zinc-air batteries. Identify the correct battery size (312 or 13) by:

- Checking "Your CROS device" on page 3.
- Checking the marking on the inner side of the battery door.
- Checking the following table.

| Model | Zinc air battery size | Color marking on package | IEC code | ANSI code |
|-------------|-----------------------|--------------------------|----------|-----------|
| CROS II-312 | 312 | brown | PR41 | 7002ZD |
| CROS II-13 | 13 | orange | PR48 | 7000ZD |

 Please ensure you use the correct type of zinc-air battery in your CROS device. Please also read chapter 15.2 for further information on product safety.

6. Putting on your CROS device

6.1 Putting on your CROS device with a dome or SlimTip

1

Place the CROS device behind your ear.

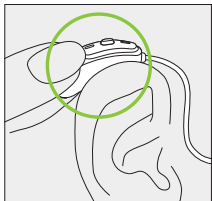

2

Insert the earpiece into your ear canal.

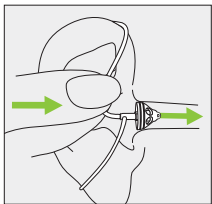

3

If there is an anchor attached to the earpiece, tuck it into the bowl of your ear to secure your CROS device.

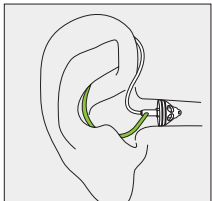

6.2 Putting on your CROS II-13 device with a classic earmold

1

Take the earmold up to your ear and place the canal portion into your ear canal.

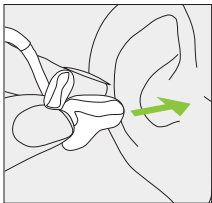

2

Place the CROS device behind your ear.

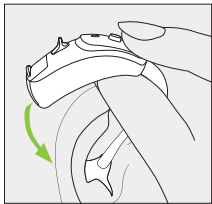

3

Insert the upper part of the earmold into the upper part of the bowl of your ear.

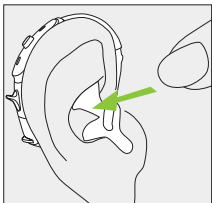

7. Removing your CROS device

7.1 Removing your CROS device with a dome or SlimTip

1

Pull on the bend of the tube and remove the CROS device from behind the ear.

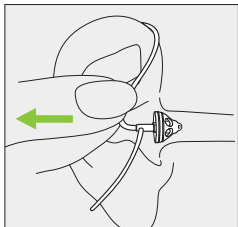

⚠ In very rare cases, your earpiece can remain in your ear canal when removing the device from the ear. In the unlikely case that the earpiece does get stuck in your ear canal, it is strongly recommended to see a medical specialist for safe removal.

7.2 Removing your CROS II-13 device with a classic earmold

1

Lift the device above the upper part of your ear.

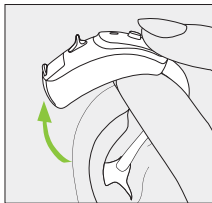

2

Grasp the earmold in your ear and gently remove it.

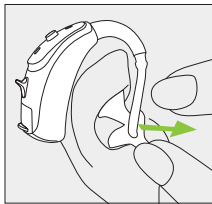

i Please try to avoid pinching the tube to remove the CROS device.

8. Push button

The push button on your CROS device can have various functions. This depends on the programming of the CROS device, which is indicated in your individual "Hearing aid instructions". Please ask your hearing care professional for this printout.

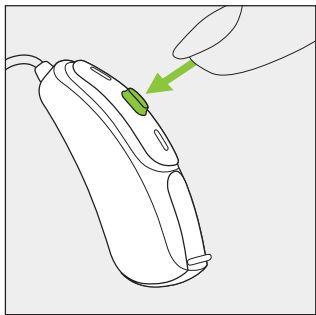

9. Volume control

CROS II-13 only:

To increase the volume, press the volume control upwards. To decrease the volume, press the volume control downwards.

The volume control of your CROS device can have various functions. This depends on the programming, which is indicated in your individual "Hearing aid instructions". Please ask your hearing care professional for this printout.

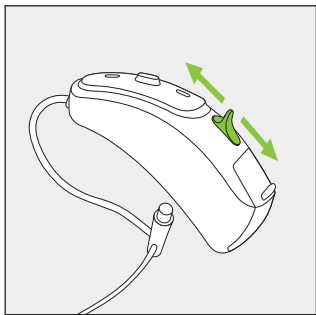

10. Care and maintenance

Routine care of your CROS device contributes to outstanding performance and a long service life.

Please use the following specifications as a guideline. Further information regarding product safety, see chapter 15.2.

General information

Before using hair spray or applying cosmetics, you should remove your CROS device from your ear, as these products may damage it.

When you are not using your CROS device, leave the battery door open so that any moisture can evaporate. Make sure that you always completely dry your CROS device after use. Store it in a safe, dry and clean place.

Your CROS device is resistant to water, sweat and dust under the following conditions:

- The battery door is fully closed. Ensure that no foreign object such as hair is caught in the battery door when it is closed.
- After exposure to water, sweat or dust, the device is cleaned and dried.
- The CROS device is used and maintained as described in this user guide.

ⓘ Use of your CROS device around water can restrict air flow to the batteries causing it to stop working. Should your CROS device stop working after coming into contact with water, refer to the troubleshooting steps in chapter 14.

Daily

Inspect the earpiece (dome or SlimTip) for earwax and moisture. Clean the surfaces with a lint-free cloth or use the small brush provided in the hard case. Never use cleaning agents such as household detergents, soap, etc. for cleaning your CROS device. It is not recommended to rinse with water. If you need to clean your CROS device intensively, ask your hearing care professional for advice and information on drying capsules.

Weekly

Clean the earpiece (dome or SlimTip) with a soft, damp cloth or with a special cleaning cloth for hearing aids. For more in depth maintenance instructions, or for more than basic cleaning, please see your hearing care professional.

Monthly

Inspect your tube for color changes, hardening, or cracks. In the case of such changes, the tube has to be replaced. Please see your hearing care professional.

11. Service and warranty

Local warranty

Please ask the hearing care professional, where you purchased your CROS device, about the terms of the local warranty.

International warranty

Phonak offers a one year limited international warranty, valid starting from the date of purchase. This limited warranty covers manufacturing and material defects in the CROS device itself, but not accessories such as batteries, tubes, earmolds, and external receivers. The warranty only comes into force if a proof of purchase is shown.

The international warranty does not affect any legal rights that you might have under applicable national legislation governing sale of consumer goods.

Warranty limitation

This warranty does not cover damage from improper handling or care, exposure to chemicals or undue stress. Damage caused by third parties or non-authorized service centers renders the warranty null and void. This warranty does not include any services performed by a hearing care professional in their office.

Serial number:

Authorized hearing care
professional (stamp/signature):

Date of purchase:

12. Compliance information

Europe:

Declaration of Conformity

Hereby Phonak AG declares that this Phonak product meets the requirements of the Medical Devices Directive 93/42/EEC as well as the Radio and Telecommunications Terminal Equipment Directive 1999/5/EC. The full text of the Declaration of Conformity can be obtained from the manufacturer or the local Phonak representative whose address can be taken from the list on www.phonak.com (Phonak worldwide locations).

Australia:

Supplier Code Number

 N15398

New Zealand:

Supplier Code Number

Z1285

The wireless models listed on page 2 are certified under:

Phonak CROS II-312

| | |
|--------|----------------------------|
| USA | FCC ID: KWC-WHSRIC2 |
| Canada | IC: 2262A-WHSRIC2 |

Phonak CROS II-13

| | |
|--------|----------------------------|
| USA | FCC ID: KWC-WHSRIC4 |
| Canada | IC: 2262A-WHSRIC4 |

Notice 1:

This device complies with Part 15 of the FCC Rules and with RSS-210 of Industry Canada. Operation is subject to the following two conditions:

- 1) this device may not cause harmful interference, and
- 2) this device must accept any interference received, including interference that may cause undesired operation.

Notice 2:

Changes or modifications made to this device not expressly approved by Phonak may void the FCC authorization to operate this device.

Notice 3:

This device has been tested and found to comply with the limits for a Class B digital device, pursuant to Part 15 of the FCC Rules and ICES-003 of Industry Canada. These limits are designed to provide reasonable protection against harmful interference in a residential installation. This device generates, uses and can radiate radio frequency energy and, if not installed and used in accordance with the instructions, may cause harmful interference to radio communications. However, there is

no guarantee that interference will not occur in a particular installation. If this device does cause harmful interference to radio or television reception, which can be determined by turning the equipment off and on, the user is encouraged to try to correct the interference by one or more of the following measures:

- Reorient or relocate the receiving antenna.
- Increase the separation between the device and receiver.
- Connect the device into an outlet on a circuit different from that to which the receiver is connected.
- Consult the dealer or an experienced radio/TV technician for help.

13. Information and description of symbols



With the CE symbol, Phonak AG confirms that this Phonak product – including accessories – meets the requirements of the Medical Devices Directive 93/42/EEC as well as the R&TTE Directive 1999/5/EC on radio and telecommunications equipment. The numbers after the CE symbol correspond to the code of certified institutions that were consulted under the above-mentioned directives.



This symbol indicates that the products described in these user instructions adhere to the requirements for an applied part of Type B of EN 60601-1. The surface of the device is specified as an applied part of Type B.



Indicates the medical device manufacturer, as defined in EU Directive 93/42/EEC.



EMC and Radio communications compliance label Australia.



This symbol indicates that it is important for the user to read and take into account the relevant information in these user guides.



This symbol indicates that it is important for the user to pay attention to the relevant warning notices in these user guides.



Important information for handling and product safety.

Operating conditions

The product is designed such that it functions without problems or restrictions if used as intended, unless otherwise noted in these user guides.



Temperature during transportation and storage: -20° to $+60^{\circ}$ Celsius (-4° to $+140^{\circ}$ Fahrenheit).



Humidity during transportation: Up to 90% (non condensing). Humidity during storage: 0% to 70%, if not in use. See instruction in chapter 15.2 regarding drying the device after use.



Atmospheric pressure: 200 hPa to 1500 hPa



The symbol with the crossed-out garbage bin is to make you aware that this device may not be thrown away as normal household waste. Please dispose of old or unused device, at waste disposal sites intended for electronic waste, or give your device to your hearing care professional for disposal. Proper disposal protects the environment and health.

14. Troubleshooting

Problem

CROS device not functioning

Hearing aid plays two beeps

Hearing aid plays two beeps followed by a melody 

Sound switches on & off (intermittent)

Causes

Dead battery

Battery not inserted correctly

CROS device switched off

Hearing aid switched off

Indication for low hearing aid battery

Indication for low battery of CROS device

Moisture on battery of hearing aid or CROS device

 If the problem persists, contact your hearing care professional for assistance

What to do

Change battery (chapter 1 + 5)

Insert battery correctly (chapter 1 + 5)

Switch CROS device on by completely closing the battery door (chapter 4)

Switch hearing aid on by completely closing the battery door (consult the user guide of the hearing aid if necessary)

Change battery of the hearing aid within the next 30 minutes (consult the user guide of the hearing aid if necessary)

Change battery of the CROS device within the next 30 minutes (chapter 1 + 5)





Wipe batteries and housing of the hearing aid and the CROS device with a dry cloth

15. Important safety information

Please read the information on the following pages before using your CROS device.

A CROS device will not restore normal hearing and will not prevent or improve a hearing impairment resulting from organic conditions. Infrequent use does not permit a user to attain full benefit from it. The use of a CROS device is only part of hearing habilitation and may need to be supplemented by auditory training and instruction in lipreading.

15.1 Hazard warnings

-  The intended use of a CROS device is to transmit sound to a hearing aid on the better hearing ear and hereby compensate for impaired hearing. The CROS system (specially programmed for each hearing loss) must only be used by the intended person. It should not be used by any other person as it could damage hearing.
-  Do not use the CROS system in explosive areas (mines or industrial areas with danger of explosions, oxygen rich environments or areas where flammable anesthetics are handled) or where electronic equipment is prohibited.
-  Changes or modifications to the CROS system that were not explicitly approved by Phonak are not permitted. Such changes may damage your ear or the CROS system.
-  Hearing aid batteries are toxic if they are swallowed. Keep out of reach of children. If batteries are swallowed, consult your physician immediately!

 If you feel pain in or behind your ear, if it is inflamed or if skin irritation and accelerated accumulations of earwax occur, please check with your hearing care professional or physician.

 In very rare cases, the earpiece can remain in your ear canal when removing the tube from the ear. In the unlikely case that the earpiece does get stuck in your ear canal, it is strongly recommended to see a physician for safe removal.

 Programs with the directional microphone mode reduce background noises. Please be aware that warning signals or noises coming from behind, e. g. cars, are partially or entirely suppressed.

 This CROS system is not for children below 36 months. It contains small parts that can cause choking, if swallowed by children. Keep out of reach of children under 3 years. If swallowed, consult a physician or hospital immediately.

 External devices may only be connected if they have been tested in accordance with corresponding IECXXXXX standards. Only use accessories approved by Phonak AG, to avoid any electrical shock.

 The following is only applicable for persons with active implantable medical devices (i.e. pacemakers, defibrillators, etc.):

- Keep the wireless hearing aid or CROS device at least 15 cm (6 inches) away from the active implant. If you experience any interference, do not use the wireless hearing aids or CROS device and contact the manufacturer of the

active implant. Please, note that interference can also be caused by power lines, electrostatic discharge, airport metal detectors etc.

- Keep magnets (i.e. battery handling tool, EasyPhone magnet, etc.) at least 15 cm (6 inches) away from the active implant.

15.2 Information on product safety

- ① Phonak CROS devices are water resistant and not waterproof. They are designed to withstand normal activities and occasional accidental exposure to extreme conditions. Never immerse your CROS device in water. Phonak CROS devices are not specifically designed for extended periods of water submersion on a continual basis. They should not be worn in activities such as swimming or bathing. Always remove your CROS device before these activities, as the CROS devices contain sensitive electronic parts.
- ① Never wash the microphone inputs. Doing so could cause it to lose its special acoustic features.
- ① Protect your CROS device from heat (never leave near a window or in the car). Never use a microwave or other heating devices to dry your CROS device. Ask your hearing care professional about suitable drying methods.
- ① When you are not using your CROS device, leave the battery door open so that any moisture can evaporate. Make sure that you always completely dry

your CROS device after use. Store the CROS device in a safe, dry and clean place.

i Do not drop your CROS device! Dropping onto a hard surface can damage your CROS device.

i Always use new batteries for your CROS device. In case a battery is leaking, replace it immediately with a new one to avoid any skin irritation. You can return used batteries to your hearing care professional.

i The batteries used in the CROS device should not exceed 1.5 Volts. Please do not use silver-zinc or Li-ion (lithium-ion) rechargeable batteries as these may cause severe damage to your CROS device. The table in chapter 5 explains exactly which type of battery your CROS device requires.

i Remove the battery if you are not using your CROS device for a long period of time.

① Special medical or dental examination including radiation described below, may adversely affect the correct functioning of your CROS device. Remove and keep them outside the examination room/area before undergoing:

- Medical or dental examination with X-ray (also CT scan).
- Medical examinations with MRI/NMRI scans, generating magnetic fields.
- CROS devices don't need to be removed when passing security gates (airports etc.). If X-ray is used at all, it will be in very low doses, and will not affect the CROS device.

① Do not use your CROS device in areas where electronic equipment is prohibited.

16. Important information: Cell phones

Some hearing aid users have reported a buzzing sound in their hearing aids when they are using cell phones. According to the ANSI 63.19 (American National Standard Methods of Measurement of Compatibility between Wireless Communications Devices and Hearing Instruments) standard, the compatibility of a particular hearing aid and cell phone can be predicted by adding the rating for the hearing aid immunity to the rating for the cell phone emissions. The sum of the hearing aid rating (e.g. M2/T2=2) and the telephone rating (e.g. M3/T3=3) is 5, and any combination that equals 5 will provide "normal use"; a sum of 6 or greater would indicate "excellent performance". The equipment performance measurements, categories and system classifications are based upon the best information available but cannot guarantee that all users will be satisfied. The immunity of this hearing aid is at least M2/T2.

Note: the performance of individual hearing aids may vary with individual cell phones. Therefore, please try the hearing aid with your cell phone or, if you are purchasing a new phone, be sure to try it with your hearing aid prior to purchase. For additional guidance, please ask your hearing care professional for the booklet entitled "hearing aid compatibility with digital wireless cell phones".

17. For the US market only, complies with the FDA regulations

Warning to Hearing Aid Dispensers

A hearing aid dispenser should advise a prospective hearing aid user to consult promptly with a licensed physician (preferably an ear specialist) before dispensing a hearing aid if the hearing aid dispenser determines through inquiry, actual observation, or review of any other available information concerning the prospective user, that the prospective user has any of the following conditions:

- (i) Visible congenital or traumatic deformity of the ear.
- (ii) History of active drainage from the ear within the previous 90 days.
- (iii) History of sudden or rapidly progressive hearing loss within the previous 90 days.
- (iv) Acute or chronic dizziness.

-
- (v) Unilateral hearing loss of sudden or recent onset within the previous 90 days.
 - (vi) Audiometric air-bone gap equal to or greater than 15 decibels at 500 hertz (Hz), 1,000 Hz, and 2,000 Hz.
 - (vii) Visible evidence of significant cerumen accumulation or a foreign body in the ear canal.
 - (viii) Pain or discomfort in the ear. Special care should be exercised in selecting and fitting a hearing aid whose maximum sound pressure level exceeds 132 decibels because there may be risk of impairing the remaining hearing of the hearing aid user. (This provision is required only for those hearing aids with a maximum sound pressure capability greater than 132 decibels (dB).)

Important Notice for Prospective Hearing Aid Users

Good health practice requires that a person with a hearing loss have a medical evaluation by a licensed physician (preferably a physician who specializes in diseases of the ear) before purchasing a hearing aid.

Licensed physicians who specialize in diseases of the ear are often referred to as otolaryngologists, otologists or otorhinolaryngologists. The purpose of medical evaluation is to assure that all medically treatable conditions that may affect hearing are identified and treated before the hearing aid is purchased.

Following the medical evaluation, the physician will give you a written statement that states that your hearing loss has been medically evaluated and that you may be considered a candidate for a hearing aid. The physician will refer you to an audiologist or a hearing aid dispenser, as appropriate, for a hearing aid evaluation.

The audiologist or hearing aid dispenser will conduct a hearing aid evaluation to assess your ability to hear with and without a hearing aid. The hearing aid evaluation will enable the audiologist or dispenser to select and fit a hearing aid to your individual needs.

If you have reservations about your ability to adapt to amplification, you should inquire about the availability of a trial-rental or purchase-option program. Many hearing aid dispensers now offer programs that permit

you to wear a hearing aid for a period of time for a nominal fee after which you may decide if you want to purchase the hearing aid.

Federal law restricts the sale of hearing aids to those individuals who have obtained a medical evaluation from a licensed physician. Federal law permits a fully informed adult to sign a waiver statement declining the medical evaluation for religious or personal beliefs that preclude consultation with a physician. The exercise of such a waiver is not in your best health interest and its use is strongly discouraged.

Children with Hearing Loss

In addition to seeing a physician for a medical evaluation, a child with a hearing loss should be directed to an audiologist for evaluation and rehabilitation since hearing loss may cause problems in language development and the educational and social growth of a child. An audiologist is qualified by training and experience to assist in the evaluation and rehabilitation of a child with a hearing loss.



Manufacturer:

Phonak LLC

4520 Weaver Parkway

Warrenville, IL 60555

www.phonak-us.com

CE
0459

