

How to Connect with Phonak's TV Connector

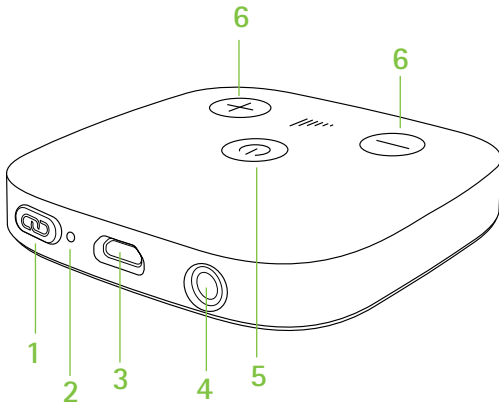

Device Description

1. Connect button
2. Indicator light (LED)
3. microUSB power socket
4. Audio socket for optical (Toslink) or analog (3.5 mm jack) cable
5. Power button
6. Volume up and down buttons

General Operation

The TV connector allows you to connect your Phonak Marvel hearing aids to your TV or other entertainment/communication devices. It uses Phonak's AirStream™ technology to transmit sound from your audio device into your hearing aids, which will result in less battery consumption than traditional Bluetooth solutions.

- **To switch on**, ensure your TV Connector is plugged into a power supply (outlet or USB cable plugged into your computer). Press the power button until you see the indicator light turn on: you will see a solid white light if the device is on but no audio is being transmitted and you will see a solid green light when the TV connector is transmitting audio.
Your hearing aids may be set to "Manual" for you to access the audio via the TV connector. If this is the case you will need to press a button on your hearing aids or app; otherwise, your hearing aids should automatically receive the signal.
- **To switch off**, press the power button until you see the indicator light fade out and disappear or simply unplug the TV connector from its power supply.





Connecting to Your Hearing Aids

Pair your TV Connector to your hearing aids. This process only needs to be completed once.

- The connection to your hearing aids will be initiated automatically as soon as your devices are turned on and you plug in your TV connector to a power supply for the first time.
- If that connection was not established, press the Connect button on the back of your TV connector and the light will start blinking blue. **Figure 1**
- Turn on the hearing aids and ensure they are within 1 meter of the TV connector.
- You will hear a confirmation beep in your hearing aids when the connection was successful.

Figure 1

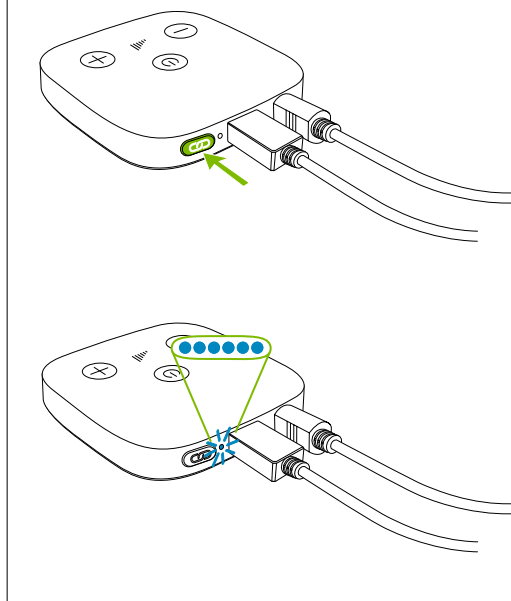

Connecting to Computers/Tablets

1. Ensure your TV connector is plugged into a power supply and is powered on.
2. Insert one end of the 3.5 mm audio cable into your TV connector and the other end into the headphone socket of your audio device (Computer/Tablet/Phone). **Figure 2**
3. Start the audio on your computer/tablet/phone and the audio streaming will automatically start.

Figure 2

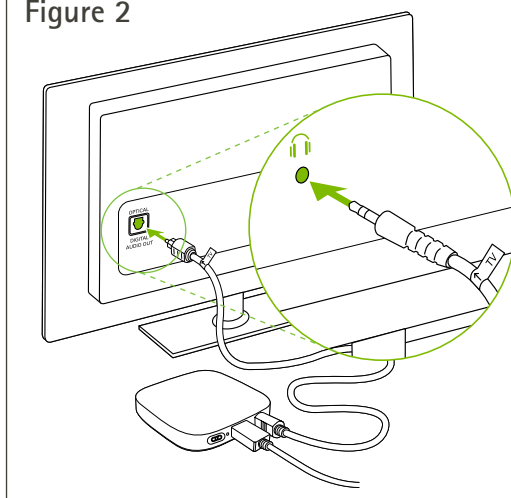

More Use Cases

There are many situations where your TV connector will allow you to stream audio wirelessly from the TV connector to your hearing aids.

Here is a break down based on cell phone and laptop compatibility.



TV Connector Compatibility with...

	CELL PHONE	LAPTOP
FACEBOOK MESSENGER	😊	😊
GOOGLE DUO	😊	😊
FACETIME	😊	😊
MICROSOFT TEAMS	😊	😊
SAMSUNG TABLET	😊	😊
SKYPE	😊	😊
WHATSAPP	😊	😊
YOUTUBE	😊	😊
ZOOM	😊	😊

- With the video conferencing applications above, audio is heard in the hearing aids but speech is taken from your device (cell/laptop) microphone.
- If no audio is detected for 30 seconds, the audio from your device will stop streaming until audio is resumed.

Tip 1 If your Marvel hearing aids are paired to any devices such as a cell phone or tablet, ensure the Bluetooth is turned off in those devices when using the TV Connector to stream. Bluetooth notifications or audio will kick you out of your TV Connector streaming signal.

Tip 2 When you are finished streaming from your TV connector, press your hearing aid program button to get back to regular hearing aid use.